

MINI HYBRID SERIES CONNECTOR



Mini Hybrid Connector – A compact, single connection point with a smaller form factor that is ideal for use in low-pressure applications where ease of use and ergonomics are important. This connector makes it easy to connect power, signal and gases in one simple motion.

FEATURES

- Easy-to-use breakaway design
- Small package design
- Streamlined exterior
- Proven design

BENEFITS

- Quick, automatic disconnect
- Minimize device size
- Clean, attractive appearance
- Accelerate product development

Specifications ● ● ●

PRESSURE:

Vacuum to 25 psi, 1.7 bar

TEMPERATURE:

40°F to 80°F (4°C to 27°C)

MATERIALS:

External coupler components: PET

Air coupler components: Acetal

Springs: Stainless steel

Panel Mount Nut: Zinc-plated steel

Electrical contacts: Gold-plated copper alloy

O-rings: Buna-N

Air line: PVC

COLOR: Gray

EXTERNAL UMBILICAL HOSE: 4 feet (121 cm) PVC

WIRE: 22AWG PVC jacket

TERMINATIONS:

Panel: 1/16" hose barb and two 22AWG wires with 11" pigtail

Umbilical: 4' (121 cm) umbilical with one 1/16" ID PVC tube and two 22AWG wires with 6" pigtail

Number of air lines: 1

ELECTRICAL SPECIFICATIONS

Voltage: Up to 24VDC

Current: Up to 3 Amps

Wire: 22AWG with PVC jacket

Number of contacts: 2

MINI HYBRID SERIES DIMENSIONS

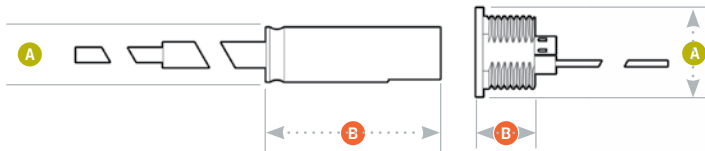

A = Height/Diameter
B = Total Length

Panel Dimensions

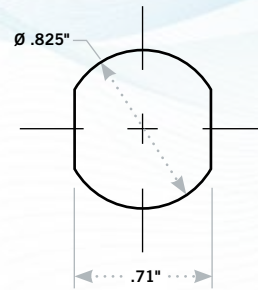

Coupling Hose • PET AND ACETAL

	CONFIGURATION HOSE	FLOW PATH 1/16" ID (1.6mm)	PART NO. MHQC17000	A .62	B 2.00
---	------------------------------	--------------------------------------	------------------------------	-----------------	------------------

Coupling Panel • PET AND ACETAL

	CONFIGURATION PANEL MOUNT	FLOW PATH 1/16" ID (1.6mm)	PART NO. MHQC42000	A 1.00	B .60
---	-------------------------------------	--------------------------------------	------------------------------	------------------	-----------------

NOTES:

