

# Adapters



**200 Series**

**280 Series**

**700 Series**

## Product Features

### 200 Series

- Zinc plated steel

### 280 Series

- Nickel plated brass

### 700 Series

- Zinc plated steel
- \*EL is brass

## Physical Characteristics

Series	Max. Operating Pressure	
	(bar)	(psi)
200	120-250	1740-3625
280	60	870
700	35	508

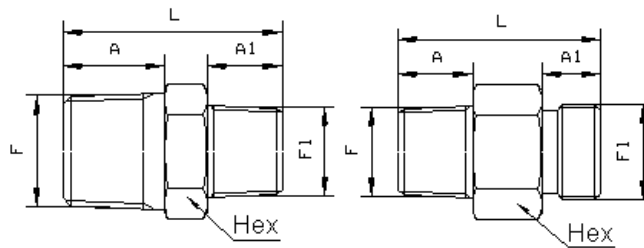

Figure 1

Figure 2

## 200 Series

### Male BSP Taper Nipple

Connection F	Connection F1	Part Number	Fig.	Dimensions				Weight	Pressure
				L	A	Hex	A1		
				(mm)	(mm)	(mm)	(mm)	(g)	(bar)
R 1/8	R 1/8	MA0024318	1	26	10	12	10	13	250
R 1/4	R 1/8	MA0024484	1	31	14	14	10	20	250
R 3/8	R 1/8	MA0024588	1	32	15	17	9	29	250
R 1/4	R 1/4	MA0024314	1	35	14	14	14	25	250
R 3/8	R 1/4	MA0024448	1	36	15	17	14	34	250
R 1/2	R 1/4	MA0024524	1	41	19	22	14	62	250
R 3/8	R 3/8	MA0024338	1	37	15	17	15	39	250
R 1/2	R 3/8	MA0024482	1	42	19	22	15	67	250
R 3/4	R 3/8	MA0024548	1	44	20	27	15	95	175
R 1/2	R 1/2	MA0024312	1	46	19	22	19	68	250
R 3/4	R 1/2	MA0024424	1	48	20	27	19	94	175
R 1	R 1/2	MA0024512	1	53	24	36	19	191	150
R 3/4	R 3/4	MA0024334	1	49	20	27	20	107	175
R 1	R 3/4	MA0024441	1	54	24	36	20	182	150
R 1	R 1	MA0024310	1	58	24	36	24	205	150

### Male BSP Taper/Metric Male Nipple

Connection F	Connection F1	Part Number	Fig.	Dimensions				Weight	Pressure
				L	A	Hex	A1		
				(mm)	(mm)	(mm)	(mm)	(g)	(bar)
R 1/4	M 14 x 1.25	MA0024145	2	31	13	16	12	24	250
R 3/8	M 18 x 1.25	MA0024188	2	33	14	22	11	44	250

# Adapters

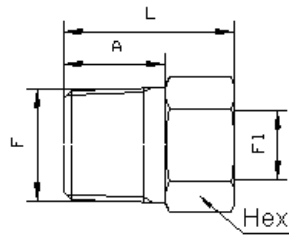

Figure 3

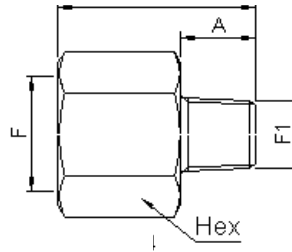

Figure 4

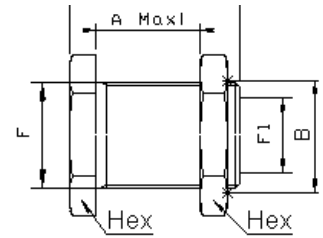

Figure 5

## 200 Series (cont.)

### Reducing Bush

Connection F	Connection F1	Part Number	Fig.	Dimensions				Weight	Pressure
				L	A	Hex	A1		
				(mm)	(mm)	(mm)	(mm)	(g)	(bar)
R 1/4	G 1/8	MA0025548	3	21	14	14	-	14	250
R 3/8	G 1/8	MA0025688	3	22	15	17	-	27	250
R 3/8	G 1/4	MA0025584	3	23	15	19	-	20	250
R 1/2	G 1/4	MA0025624	3	27	19	22	-	49	250
R 1/2	G 3/8	MA0025528	3	27	19	22	-	37	250
R 3/4	G 3/8	MA0025648	3	29	20	27	-	77	175
R 3/4	G 1/2	MA0025542	3	29	20	27	-	52	175
R 1	G 1/2	MA0025612	3	34	24	36	-	139	150
R 1	G 3/4	MA0025514	3	34	24	36	-	100	150

### Female/Male Reducer

Connection F	Connection F1	Part Number	Fig.	Dimensions				Weight	Pressure
				L	A	Hex	A1		
				(mm)	(mm)	(mm)	(mm)	(g)	(bar)
G 1/4	R 1/8	MA0024248	4	31	10	19	-	40	250
G 3/8	R 1/8	MA0026888	4	32	10	22	-	49	250
G 3/8	R 1/4	MA0024284	4	35	14	22	-	46	250
G 1/2	R 1/4	MA0026824	4	41	14	27	-	84	250
G 1/2	R 3/8	MA0024228	4	40	15	27	-	80	250
G 3/4	R 3/8	MA0026848	4	44	15	36	-	172	175
G 3/4	R 1/2	MA0024242	4	47	19	32	-	125	175
G 1	R 1/2	MA0026812	4	56	19	41	-	230	150
G 1	R 3/4	MA0024214	4	55	20	41	-	240	150

### Bulkhead Reducer

Connection F	Connection F1	Part Number	Fig.	Dimensions				Weight	Pressure
				L	A Max.	Hex	B		
				(mm)	(mm)	(mm)	(mm)	(g)	(bar)
G 1/4	G 1/8	MA0027848	5	20	14	19	13.5	17	250
G 3/8	G 1/4	MA0027884	5	28	20	22	17	29	250
G 1/2	G 3/8	MA0027828	5	32	21	26	21.5	46	250
G 3/4	G 1/2	MA0027842	5	36	24	32	27	86	120

# Adapters

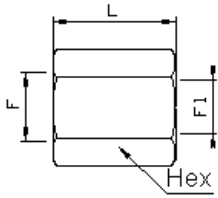

Figure 1

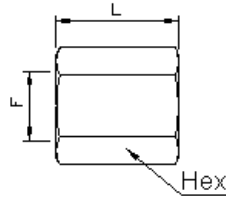

Figure 2

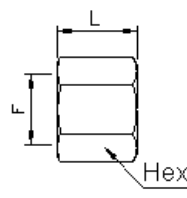

Figure 3

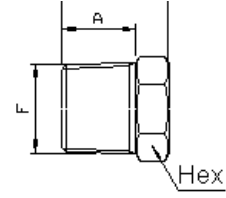

Figure 4

## 200 Series (cont.)

### Reducing Socket

Connection F	Connection F1	Part Number	Fig.	Dimensions		Hex	A1	Weight	Pressure
				L	A				
				(mm)	(mm)	(mm)	(mm)	(g)	(bar)
G 1/4	G 1/8	MA0026748	1	24	-	19	-	39	250
G 3/8	G 1/4	MA0026784	1	27	-	22	-	53	250
G 1/2	G 3/8	MA0026728	1	32	-	27	-	89	250
G 3/4	G 1/2	MA0026742	1	36	-	32	-	126	175
G 1	G 3/4	MA0026714	1	45	-	41	-	131	150

### Equal Socket

Connection F	Connection F1	Part Number	Fig.	Dimensions		Hex	A1	Weight	Pressure
				L	A				
				(mm)	(mm)	(mm)	(mm)	(g)	(bar)
G 1/8	-	MA0026918	2	20	-	14	-	17	250
G 1/4	-	MA0026914	2	25	-	19	-	35	250
G 3/8	-	MA0026938	2	27	-	22	-	45	250
G 1/2	-	MA0026912	2	35	-	27	-	76	250
G 3/4	-	MA0026934	2	40	-	32	-	113	175
G 1	-	MA0026910	2	45	-	41	-	217	150

### Female-Threaded Cap

Connection F	Connection F1	Part Number	Fig.	Dimensions		Hex	A1	Weight	Pressure
				L	A				
				(mm)	(mm)	(mm)	(mm)	(g)	(bar)
G 1/8	-	MA0024618	3	17	-	14	-	23	250
G 1/4	-	MA0024614	3	22	-	19	-	29	250
G 3/8	-	MA0024638	3	24	-	22	-	38	250
G 1/2	-	MA0024612	3	30	-	27	-	70	250
G 3/4	-	MA0024634	3	32	-	32	-	91	175
G 1	-	MA0024610	3	41	-	41	-	176	150

### Male-Threaded Cap

Connection F	Connection F1	Part Number	Fig.	Dimensions		Hex	A1	Weight	Pressure
				L	A				
				(mm)	(mm)	(mm)	(mm)	(g)	(bar)
R 1/8	-	MA0026618	4	16	10	12	-	10	250
R 1/4	-	MA0026614	4	21	14	14	-	22	250
R 3/8	-	MA0026638	4	22	15	17	-	31	250
R 1/2	-	MA0026612	4	27	19	22	-	55	250
R 3/4	-	MA0026634	4	29	20	27	-	89	175
R 1	-	MA0026610	4	34	24	36	-	164	150

FLUID TRANSFER  
AND HYDRAULIC

PNEUMATIC

SPECIAL APPLICATIONS

DIAGNOSTIC

AGRICULTURE

REFRIGERANT

# Adapters

FLUID TRANSFER  
AND HYDRAULIC



Figure 1



Figure 2

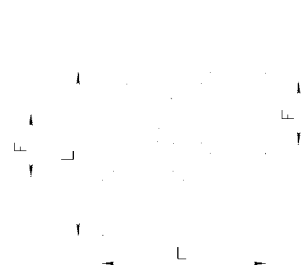

Figure 3



Figure 4

## 280 Series

### Female Tee

Connection F	Connection F1	Part Number	Fig.	Dimensions			Weight
				L	L1	Hex	
				(mm)	(mm)	(mm)	(g)
G 1/8	-	ML0028018	1	28	42	-	28
G 1/4	-	ML0028014	1	34	51	-	57
G 3/8	-	ML0028038	1	39	56	-	83
G 1/2	-	ML0028012	1	46	67	-	144
G 3/4	-	ML0028034	1	53	73	-	201
G 1	-	ML0028010	1	64	90	-	321

### Female Y-piece

Connection F	Connection F1	Part Number	Fig.	Dimensions			Weight
				L	L1	Hex	
				(mm)	(mm)	(mm)	(g)
G 1/8	-	ML0028618	2	27	29	13	19
G 1/4	-	ML0028614	2	32	36	17	34
G 3/8	-	ML0028638	2	37	41	20	44
G 1/2	-	ML0028612	2	45	53	25	93

### Female Cross

Connection F	Connection F1	Part Number	Fig.	Dimensions			Weight
				L	L1	Hex	
				(mm)	(mm)	(mm)	(g)
G 1/8	-	ML0028118	3	42	-	-	48
G 1/4	-	ML0028114	3	51	-	-	73
G 3/8	-	ML0028138	3	56	-	-	107
G 1/2	-	ML0028112	3	67	-	-	185

### 90 Degree Female Elbow

Connection F	Connection F1	Part Number	Fig.	Dimensions			Weight
				L	L1	Hex	
				(mm)	(mm)	(mm)	(g)
G 1/8	-	ML0028218	4	28	-	-	21
G 1/4	-	ML0028214	4	34	-	-	40
G 3/8	-	ML0028238	4	39	-	-	58
G 1/2	-	ML0028212	4	47	-	-	106
G 3/4	-	ML0028234	4	50	-	-	130
G 1	-	ML0028210	4	64	-	-	227

PNEUMATIC

SPECIAL APPLICATIONS

DIAGNOSTIC

AGRICULTURE

REFRIGERANT



Figure 5

## 280 Series (cont.)

### 90 Degree Male/Female Elbow

Connection F	Connection F1	Part Number	Fig.	Dimensions		Hex	Weight
				L	L1		
				(mm)	(mm)	(mm)	(g)
G 1/8	-	ML0028418	5	26	26	-	17
G 1/4	-	ML0028414	5	32	32	-	34
G 3/8	-	ML0028438	5	37	37	-	50
G 1/2	-	ML0028412	5	44	44	-	89
G 3/4	-	ML0028434	5	50	50	-	124
G 1	-	ML0028410	5	60	60	-	206



Figure 1

## 700 Series

### Male-Threaded Hose Tail

Connection F	Hose I.D.	Part Number	Fig.	Dimensions		Hex	Weight
				L	A		
				(mm)	(mm)	(mm)	(g)
R 1/8	6	EL0070267	1	32	7.5	12	10
R 1/8	7	EA0070278	1	41	9	14	15
R 1/8	8	EA0070289	1	41	9	14	16
R 1/8	9	EA0070290	1	41	9	14	18
R 1/4	6	EA0070467	1	45	13	14	18
R 1/4	7	EA0070478	1	45	13	14	19
R 1/4	8	EA0070489	1	45	13	14	20
R 1/4	9	EA0070490	1	45	13	14	20
R 1/4	10	EA0070401	1	45	13	14	21
R 1/4	11	EA0070411	1	50	13	14	24
R 1/4	12	EA0070412	1	50	13	17	31
R 1/4	13	EA0070413	1	50	13	17	36
R 3/8	7	EA0070678	1	48	14	17	31
R 3/8	8	EA0070689	1	48	14	17	32
R 3/8	9	EA0070690	1	48	14	17	33
R 3/8	10	EA0070601	1	48	14	17	33
R 3/8	11	EA0070611	1	49	14	17	33
R 3/8	12	EA0070612	1	53	14	17	36
R 3/8	13	EA0070613	1	53	14	19	43
R 3/8	16	EA0070616	1	60	14	19	50
R 1/2	8	EA0070889	1	52	17	22	50
R 1/2	11	EA0070811	1	57	17	22	55
R 1/2	12	EA0070812	1	57	17	22	55
R 1/2	13	EA0070813	1	57	17	22	58
R 1/2	16	EA0070816	1	63	17	22	61
R 1/2	19	EA0070819	1	69	17	22	73
R 3/4	16	EA0071016	1	65	19	27	85
R 3/4	19	EA0071019	1	71	19	27	100
R 3/4	25	EA0071025	1	77	19	27	130
R 1	19	EA0072019	1	76	22	35	165
R 1	25	EA0072025	1	82	22	35	203
R 1	30	EA0072030	1	94	22	35	270

# Adapters

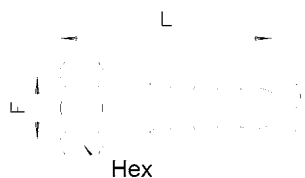

Figure 2

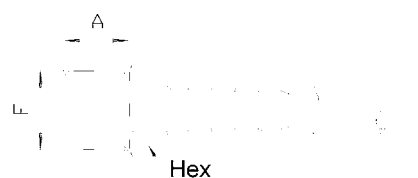

Figure 3

## 700 Series (cont.)

### Female-Threaded Hose Tail

Connection F	Hose I.D. (mm)	Part Number	Fig.	Dimensions		Hex (mm)	Weight (g)
				L (mm)	A (mm)		
G 1/4	6	EA0078167	2	45	-	17	23
G 1/4	7	EA0078178	2	45	-	17	23
G 1/4	8	EA0078189	2	45	-	17	25
G 1/4	9	EA0078190	2	45	-	17	26

### Hose Splicer

Connection F	Hose I.D. (mm)	Part Number	Fig.	Dimensions		Hex (mm)	Weight (g)
				L (mm)	A (mm)		
-	6	EA0079767	3	55	-	-	10
-	7	EA0079778	3	55	-	-	13
-	8	EA0079789	3	55	-	-	14
-	9	EA0079790	3	55	-	-	16
-	10	EA0079701	3	55	-	-	19
-	12	EA0079712	3	55	-	-	24
-	16	EA0079716	3	78	-	-	50
-	19	EA0079719	3	88	-	-	81

FLUID TRANSFER  
AND HYDRAULIC

PNEUMATIC

SPECIAL APPLICATIONS

DIAGNOSTIC

AGRICULTURE

REFRIGERANT